

## Wichtige Info / Important info

### SAF Info Nr.:3 Bereich: Technik / Technology

Datum / date:08.09.00

Thema:

**Topic:** SAF AXLES WITH DISC BRAKES

– UNIFORM MOUNTING OF THE BRAKE CALIPERS –

SAF uses the two brake sizes with disc diameter 377 mm for 19.5" and 22.5" wheels and with disc diameter 430 mm for 22.5" wheels. At request of the customer, brake calipers from different manufacturers are fitted. To date all brake calipers have been fastened to the brake mountings on the axle with 6 hexagon head collared bolts M 16x1,5 (Pos. 56). This installation method guarantees a reliable frictional mounting for the brake forces occurring up to maximum axle loads of 10 t.

In order to be able to allow disc brakes to be approved also for significantly higher axle loads (= higher braking forces) or to permit the fitting of larger wheels (= higher braking moments), this connection has to be additionally supported by a positive mounting. We have introduced this as standard into our series production in the form of a necked-down bolt with shaft diameter 19 mm for both brake sizes. This necked-down bolt (Pos. 56.1) is located in each case on the outer corner of the flange on the outgoing side in the direction of wheel rotation. The brake calipers have an additional recess for the necked-down bolt.

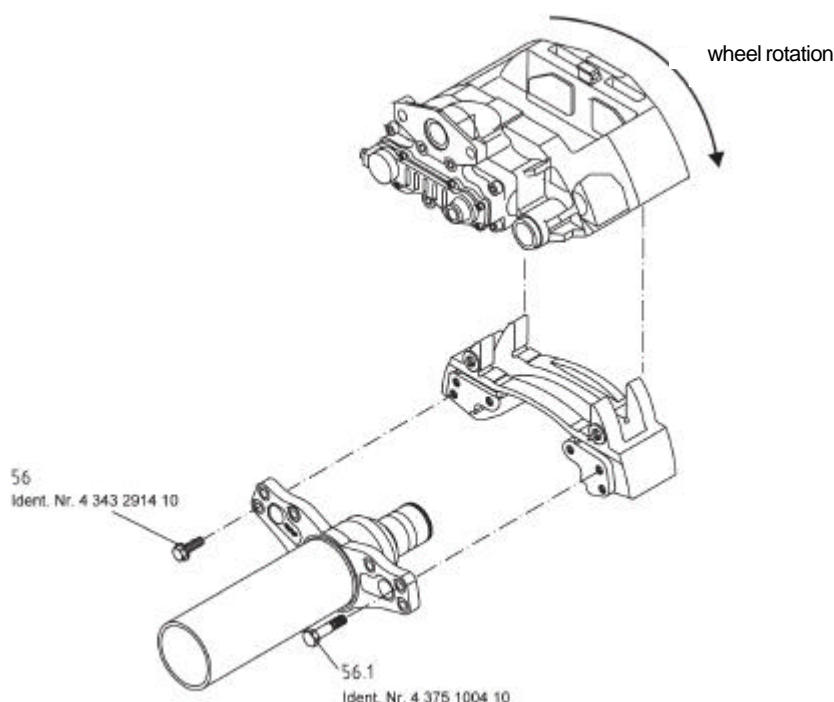

**Bolt tightening method:**

The bolt tightening method remains unchanged:

- 1) Use only original SAF bolts
- 2) Insert the bolts without additional lubricant
- 3) Tightening torque: 290 Nm, Right-hand side of vehicle in clockwise direction;  
Left-hand side of vehicle in anti-clockwise direction, in each case beginning at the necked-down bolt (if fitted).

**Identification:**

The last digit of the Ident No. of the brake calipers is the 01, e.g. 4 080 0004 00 now becomes 4 080 0004 01. This change applies for the brakes with disc diameter 430 mm from calendar week 20/2000 and for those with disc diameter 377 mm from calendar week 30/2000.

**Procedure with replacement parts:**

The modified brake calipers can also be installed on the older axles using the 6 hexagon head collared bolts M 16x1.5.

The installation of older brake calipers (without recess for the necked-down bolt) using the 6 hexagon head collared bolts M 16x1.5 is also permitted.